

INSTRUCTIONS FOR THE FOLLOWING FIXTURES:

ORDER#

MODEL#

R59025

RENO-PTL-WMB-BK

Cautions:

1. Can not use the electric generator to test the LED lamp.
2. Please abide by related country, regional and local law and regulations when install this fixture.
3. Please turn off the power before installation or maintenance.
4. Proper earth grounding is required to ensure safety.

Notice:

1. To avoid possibility of electrical shock or fire, the installation personnel must have professional electric knowledge.
2. Please wear gloves to avoid injury before installation.
3. If any smoke or spark of the wire happened, please turn off the power immediately and notify relevant personnel.

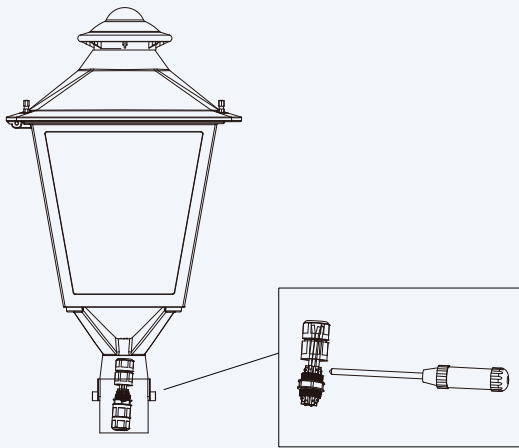
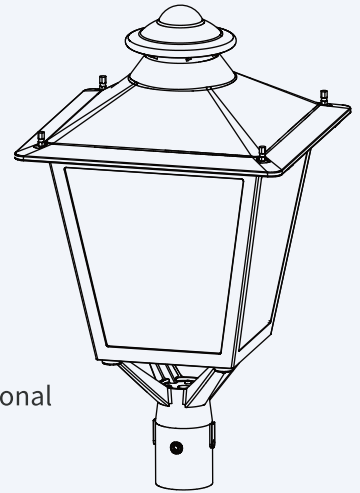

Sept 1:

Unscrew the upper part of the 3-core waterproof connector. Use a screwdriver to loosen the screws for the hot wire, ground wire, and neutral wire respectively. Secure the corresponding wires to the connector, then retighten the screws.

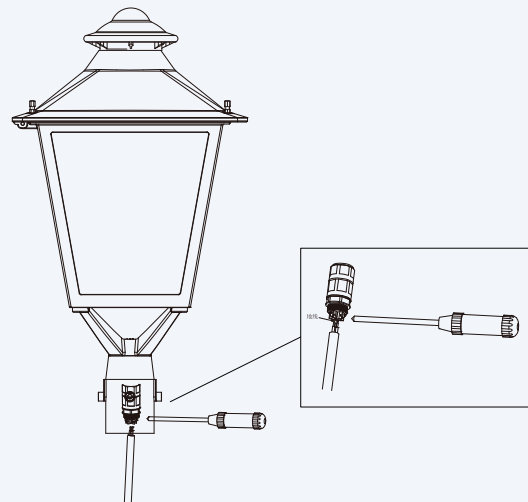

Step 2:

Unscrew the lower part of the 3-core waterproof connector. Connect the wires from the bracket to the connector: use a screwdriver to loosen the hot wire, ground wire, and neutral wire screws, secure the matching wires to the connector, and tighten the screws.



INSTALLATION INSTRUCTION

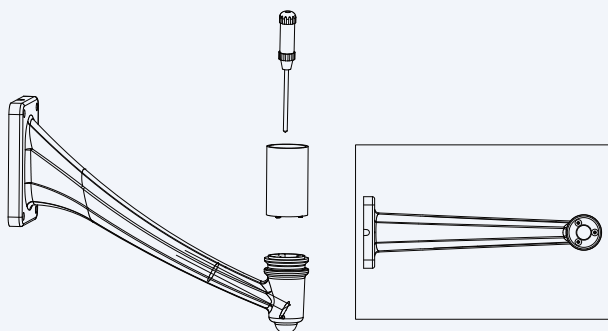

Step 3:

Align the screw holes on the sleeve with those on the wall bracket one by one, then tighten the screws onto the sleeve.

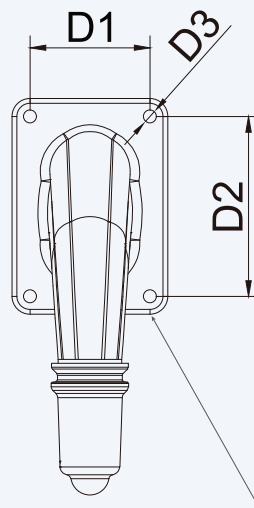

D1	100
D2	150
D3	Ø11

Step 4:

Drill holes in the wall, then install 12mm-long M8 expansion bolts.

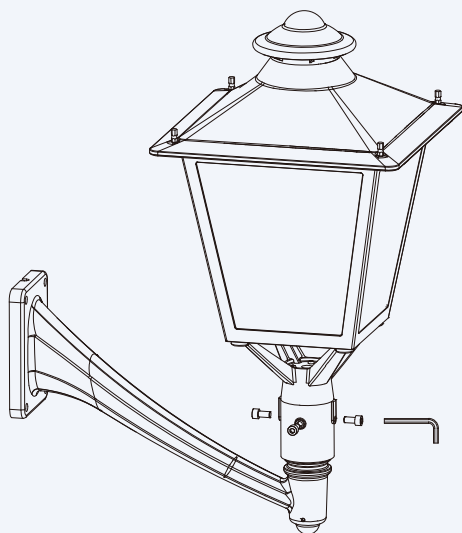

Step 5:

Insert the mounting bracket into the sleeve, and tighten the four screws with a hex key wrench.