

**INSTRUCTIONS FOR THE FOLLOWING FIXTURES:**

Order	Model
R31053	RENO-DISK-PIR-4"-5CCT

**SLIMDISK INSTALLATION GUIDE - WARNING**

**WARNING** – Read all product labels and instructions before installing fixture.

**WARNING** – Risk of fire or electric shock. LED Retrofit Kit installation requires knowledge of luminaires electrical systems. Installation should be performed only by a qualified electrician in accordance with the National Electrical Code and relevant local code.

**WARNING** – Risk of fire or electric shock. Install this kit only in the luminaires that have the construction features and dimensions shown in the photographs and/or drawings.

**WARNING** – To prevent wiring damage or abrasion, do not expose wiring to edges of sheet metal or other sharp objects.

**WARNING** – Do not make or alter any open holes in an enclosure of wiring or electrical components during kit installation.

**WARNING** – The recessed luminaire is intended for mounting only in a covered ceiling where only the led side of the luminaire will be exposed to damp or dry locations.

**WARNING** – INSTALLATION SHOULD ONLY BE PERFORMED AFTER POWER TO THE FIXTURE HAS BEEN DISCONNECTED.

**4" J-BOX INSTALLATION**

**Compatible with most standard 4" J-boxes with minimum height measuring 1.5". Not all existing J-boxes meeting these requirements will be compatible. A test installation should always be performed.**

1. Make sure the POWER IS TURNED OFF at the source to the J-box in which you are installing the product.
2. Connect the existing Black Hot wire and White Neutral wire from the Junction box to the black hot wire and white neutral wire of the downlight respectively using the provided wire nuts(fig.3).
3. Connect the ground wire from the J-box to the ground wire (green) from the downlight using a wire nut (fig. 2). Make sure the wires are tightly secured in the wire nut.
4. Remove the lens by twisting counterclockwise (fig. 4).
5. Carefully tuck all wires inside the J-box and attach the downlight to the J-box using two of the provided screws (fig. 5). Use the longer screws for a deep J-box or the shorter,screws for a shallow J-box.
6. Adjust the color temperature(2700K/3000K/3500K/4000K/5000K) to desired one, by sliding the black selector switch in the center of LED board.
7. Twist the lens clockwise until it locks in place (fig. 6).
8. Gently push the downlight up until flush with ceiling surface. (fig. 7).

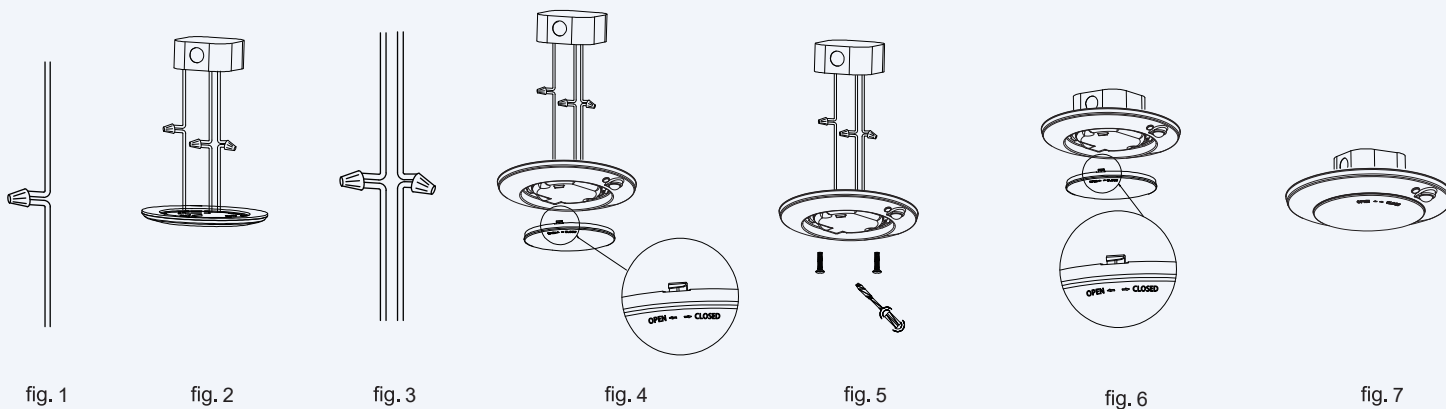

## PIR Sensor Default setting

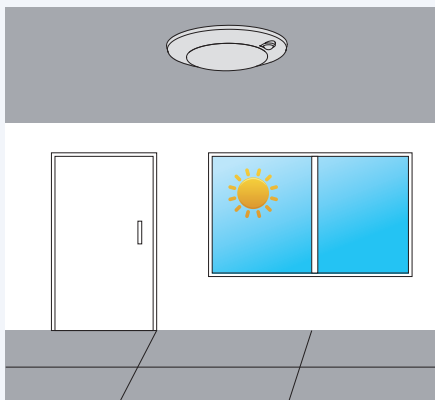

With sufficient daylight,  
even when motion detected,  
light remains OFF.

Lorsque la lumière du jour  
est suffisante, même si un mouvement  
est détecté, la lumière reste ÉTEINTE.



With insufficient daylight,  
when motion detected,  
light turns ON.

Lorsque la lumière du jour  
est insuffisante et qu'un mouvement  
est détecté, la lumière S'ALLUME.

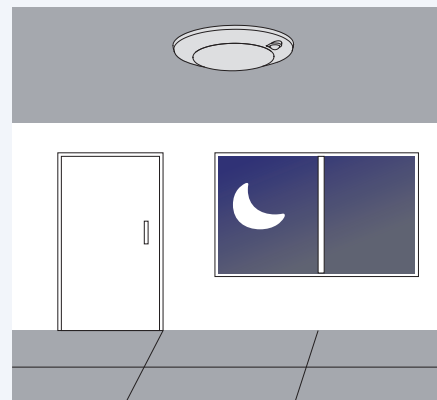

After the last detection  
and the present hold time  
has elapsed, light turns OFF.

Après la dernière détection  
et lorsque le temps de rétention  
est écoulé, la lumière S'ÉTEINT.